

MASSEY FERGUSON ADAPTOR CABLE (TRACTOR)

• CONNECT AMS CAMERAS TO YOUR DATATRONIC 3 MONITOR



Monitor
DATATRONIC 3



Adaptor cable
MF TRACTOR 1



AMS
Camera *

This adaptor cable enables the use of the DATATRONIC3 monitor for Massey Ferguson tractors with an AMS camera.

• CONNECTION TO THE MONITOR

The video input is located at the rear of the monitor, behind the foam.

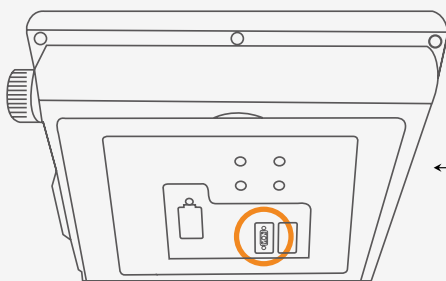

Rear of
DATATRONIC 3

Video input



Adaptor cable
MF TRACTOR 1

Extension
cable



AMS
Camera

* Camera and original monitor are not included. All the AMS cameras are compatible with this adaptor cable (except wireless camera)

MASSEY FERGUSON ADAPTOR CABLE (TRACTOR)

• VISUAL DISPLAY ON THE TOUCH-SCREEN



Press the Settings button



Select video  to display the camera.



After a few seconds with no movement, the settings menu disappears.

MASSEY FERGUSON ADAPTOR CABLE (TRACTOR)

• RECOMMENDATIONS

If your monitor DATATRONIC3 does not have a video input management system, contact Massey Ferguson for an update of the system.

• WARRANTY

The product is guaranteed for two years as from the date of sale to the end user, remembering that the sale must take place within 24 months after delivery to the concession.

• AFTER SALES SERVICE

Reserved for professionals

→ Download the service form from our site <http://pro.ams-diffusion.fr/aftersale/>

When returning, please include the following documents for managing repairs and the warranty:

- The return-authorisation form duly completed
- A copy of the invoice with the date of sale to the end user
- The reason for the claim, or a description of the malfunction.

For more information, contact our technical department

→ Tel : +33 (0)3 27 94 44 44 or @ : contact@ams-diffusion.com

If you are the end user

Please go to your dealer.



AMS Diffusion

Tél. +33 3 27 94 44 44

Fax. +33 3 27 94 44 45

contact@ams-diffusion.com